

MITSUBISHI

GOT1000 Series CF Card /Memory Card Adaptor

User's Manual

GT05-MEM-16MC
GT05-MEM-32MC
GT05-MEM-64MC
GT05-MEM-128MC
GT05-MEM-256MC
GT05-MEM-ADPC

Thank you for purchasing the GOT1000 Series.

Prior to use, please read both this manual and detailed manual thoroughly to fully understand the product.

MODEL	GT05-MEM-U
MODEL CODE	1D7M08
IB(NA)-0800302-B(0504)MEE	

GRAPHIC OPERATION TERMINAL
GOT1000

SAFETY PRECAUTIONS

(Always read these precautions before using this equipment.)

Before using this product, please read this manual and the relevant manuals introduced in this manual carefully and pay full attention to safety to handle the product correctly.

The precautions given in this manual are concerned with this product.

In this manual, the safety precautions are ranked as "DANGER" and "CAUTION".

- DANGER** Indicates that incorrect handling may cause hazardous conditions, resulting in death or severe injury.
- CAUTION** Indicates that incorrect handling may cause hazardous conditions, resulting in medium or slight personal injury or physical damage.

Note that the CAUTION level may lead to a serious accident according to the circumstances. Always follow the precautions of both levels because they are important to personal safety. Please save this manual to make it accessible when required and always forward it to the end user.

[INSTALLING PRECAUTIONS]

CAUTION

- Before installing/removing the CF card into/from the GOT, be sure to set the CF card access switch to "OFF" to turn off the CF card access LED. Failure to do so may cause data corruption or malfunction.
- When ejecting the CF card, support it by hand since it may pop out. Failure to do so may cause a fall of the CF card leading to failure or damage of the card.
- Use the CF card and memory card adaptor in the environment designated by the general specifications described in the GT15 User's Manual. Failure to do so may cause an electric shock, fire, malfunction, product damage or deterioration.

[STARTUP AND MAINTENANCE PRECAUTIONS]

CAUTION

- Never disassemble or modify the CF card and memory card adaptor. To do so may cause a failure, malfunction, injury or fire.
- Before touching the CF card or memory card adaptor, be sure to touch grounded metal or similar object to discharge the static electricity from human body. Failure to do so may cause a malfunction or failure of the unit.

[DISPOSAL PRECAUTIONS]

CAUTION

- Dispose of this product as industrial waste.

[TRANSPORTATION PRECAUTIONS]

CAUTION

- Make sure to transport the GOT main unit and/or relevant unit(s) in the manner they will not be exposed to the impact exceeding the impact resistance described in the general specifications of the GT15 User's Manual, as they are precision devices. Failure to do so may cause the unit to fail. Check if the unit operates correctly after transportation.

Manuals

The following shows manuals relevant to this product.

Detailed Manual

Manual name	Manual Number (Type code)
GT15 User's Manual (Option)	SH-080528ENG (1D7M23)

Relevant Manuals

For relevant manuals, refer to the PDF manual stored within the drawing software used.

© 2004 MITSUBISHI ELECTRIC CORPORATION

Compliance with the EMC and Low Voltage Directives

When incorporating the Mitsubishi GOT into other machinery or equipment and keeping compliance with the EMC and low voltage directives, refer to Chapter 4, "EMC Directives and Low Voltage Directives" of the manual (GT15 General Description) included with the GOT used. The CE logo is printed on the rating plate of the GOT, indicating compliance with the EMC and low voltage directives. By making this product conform to the EMC directive and low voltage instruction, it is not necessary to make those steps individually.

1. Overview

This User's Manual describes the GOT1000 series CF card and memory card adaptor (hereafter abbreviated to the CF card and memory card adaptor). There are the following CF card and memory card adaptor types. By installing the CF card, OS and project data can be transferred and functions can be increased. Refer to the GT15 User's Manual or GT11 User's Manual for the applicable GOT, to the GT Designer2 Version 2 Basic Operation/Data Transfer Manual for transfer of the OS and project data, and to the GT Designer2 Version 2 Screen Design Manual for the increased functions. The memory card adaptor converts the CF card into a memory card.

Product name	Model name	Description
CF card	GT05-MEM-16MC	Memory capacity 16M bytes
	GT05-MEM-32MC	Memory capacity 32M bytes
	GT05-MEM-64MC	Memory capacity 64M bytes
	GT05-MEM-128MC	Memory capacity 128M bytes
	GT05-MEM-256MC	Memory capacity 256M bytes
Memory card adaptor	GT05-MEM-ADPC	Converts the CF card into a memory card (TYPE II)

2. Specifications

The performance specifications of the CF card and memory card adaptor are indicated below. For the general specifications of the CF card and memory card adaptor, refer to the GT15 User's Manual or GT11 User's Manual.

Item	GT05-MEM-16MC	GT05-MEM-32MC	GT05-MEM-64MC	GT05-MEM-128MC	GT05-MEM-256MC	GT05-MEM-ADPC
Memory capacity	16M bytes	32M bytes	64M bytes	128M bytes	256M bytes	-
Number of write times	300,000 times					-
Weight	11.4g					23g

3. Part Names and External Dimensions

(1) CF card

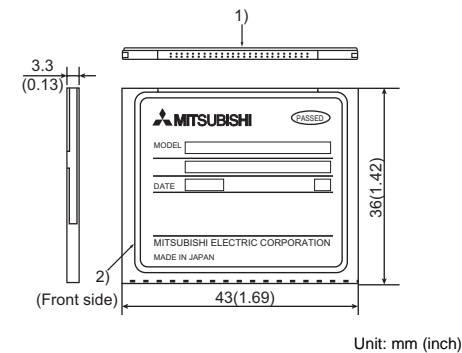

Unit: mm (inch)

No.	Name	Description
1)	Connector	For connecting the CF card interface of the GOT
2)	Rating plate	-

(2) Memory card conversion adaptor

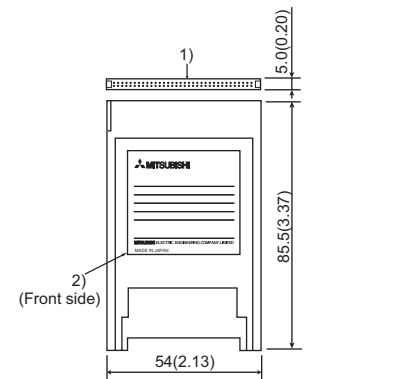

Unit: mm (inch)

No.	Name	Description
1)	Connector	For connecting the memory card interface of the personal computer
2)	Rating plate	-

4. Installing and Removing Procedures

4.1 Installing the CF Card

- Turn the CF card access switch of the GOT off.

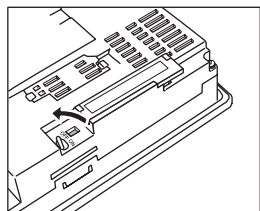

- Open the cover of the CF card interface. Insert and install the CF card into the CF card interface with its front side outside. *1

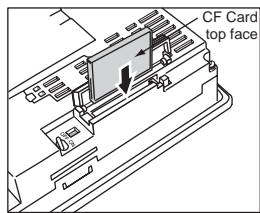

*1 CF card eject button

For the following GOTs, after installing the CF card, turn the CF card eject button to 90 degree while being pulled.

- GT1585-S, GT1575-S: Hardware version B (April, 2005) or earlier
- GT1575-V, GT1565-V: Hardware version D (April, 2005) or earlier

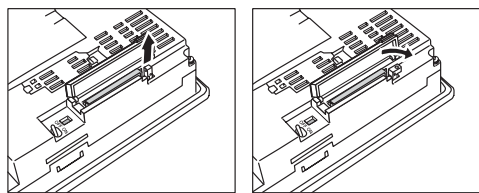

- Close the cover of the CF card interface. Set the CF card access switch to "ON".

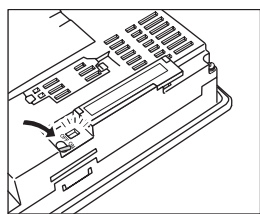

4.2 Removing the CF Card

- Turn the CF card access switch of the GOT off, and make sure that the CF card access LED has been turned off. (When the CF card access LED turns off, the CF card can be removed even during the GOT power on.)

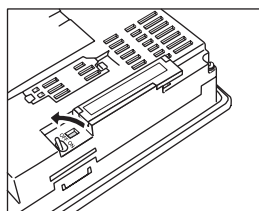

- Push the CF card eject button of the GOT. *2 (The CF card eject button is pulled out after pushing at once.)

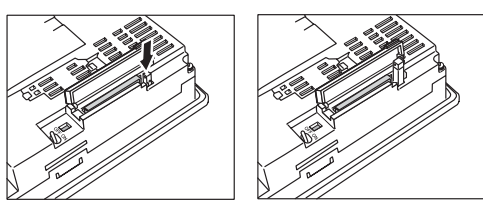

*2 CF card eject button

For the following GOTs, after opening the cover of the CF card interface, raise the CF card eject button.

- GT1585-S, GT1575-S: Hardware version B (April, 2005) or earlier
- GT1575-V, GT1565-V: Hardware version D (April, 2005) or earlier

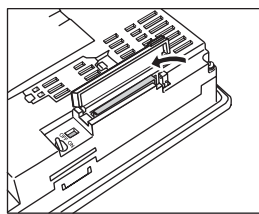

- Push the CF card eject button of the GOT to lift the CF card and remove it.

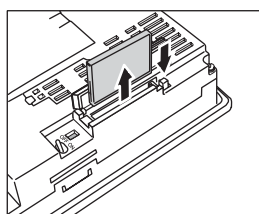

4.3 Precautions for Installing and Removing the CF Card

- While the CF card access LED is on, do not install/remove the CF card or power off the GOT. To do so may cause data corruption or malfunction.
- When ejecting the CF card, support it by hand since it may pop out. Failure to do so may cause a fall of the CF card leading to failure or damage of the card.

Warranty

Mitsubishi will not be held liable for damage caused by factors found not to be the cause of Mitsubishi; machine damage or lost profits caused by faults in the Mitsubishi products; damage, secondary damage, accident compensation caused by special factors unpredictable by Mitsubishi; damages to products other than Mitsubishi products; and to other duties.

For safe use

- This product has been manufactured as a general-purpose part for general industries, and has not been designed or manufactured to be incorporated in a device or system used in purposes related to human life.
- Before using the product for special purposes such as nuclear power, electric power, aerospace, medicine or passenger movement vehicles, consult with Mitsubishi.
- This product has been manufactured under strict quality control. However, when installing the product where major accidents or losses could occur if the product fails, install appropriate backup or failsafe functions in the system.

Country/Region Sales office/Tel

U.S.A	Mitsubishi Electric Automation Inc. 500 Corporate Woods Parkway Vernon Hills, IL 60061 Tel : +1-847-478-2100
Brazil	MELCO-TEC Rep. Com.e Assessoria Tecnica Ltda. Rua Correia Dias, 184, Edificio Paraiso Trade Center-8 andar Paraiso, Sao Paulo, SP Brazil Tel : +55-11-5908-8331
Germany	Mitsubishi Electric Europe B.V. German Branch Gothaer Strasse 9 D-40880 Ratingen, GERMANY Tel : +49-2102-486-0
U.K	Mitsubishi Electric Europe B.V. UK Branch Travellers Lane, Hatfield, Herts., AL10 8XB, UK Tel : +44-1707-276100
Italy	Mitsubishi Electric Europe B.V. Italian Branch Centro Dir. Colleoni, Pal. Perseo-Ingr.2 Via Paracelso 12, 20041 Agrate B., Milano, Italy Tel : +39-039-605344
Spain	Mitsubishi Electric Europe B.V. Spanish Branch Carretera de Rubi 76-80 08190 - Sant Cugat del Valles, Barcelona, Spain Tel : +34-93-565-3131
France	Mitsubishi Electric Europe B.V. French Branch 25 Boulevard des Bouvets, F-92741 Nanterre Cedex, France TEL: +33-1-5568-5568
South Africa	Circuit Breaker Industries LTD. Tripswath Drive, Elandsfontein Gauteng, South Africa Tel : +27-11-328-2000
Hong Kong	Ryoden Automation Ltd. 10th Floor, Manulife Tower, 169 Electric Road, North Point, HongKong Tel : +852-2887-8870
China	Ryoden Automation Shanghai Ltd. 3F Block5 Building Automation Instrumentation Plaza 103 Cao Bao Rd. Shanghai 200233 China Tel : +86-21-6120-0808
Taiwan	Settsuyo Enterprise Co., Ltd. 6F., No.105 Wu-Kung 3rd.RD, Wu-Ku Hsiang, Taipei Hsine, Taiwan Tel : +886-2-2299-2499
Korea	HAN NEUNG TECHNO CO.,LTD. 1F Dong Seo Game Channel Bldg.,660-11, Deungchon-dong Kangseok-ku, Seoul, Korea Tel : +82-2-3660-9552
Singapore	Mitsubishi Electric Asia Pte. Ltd. 307 Alexandra Road #05-01/02, Mitsubishi Electric Building Singapore 159943 Tel : +65-6473-2308
Thailand	F. A. Tech Co., Ltd. 898/28, 29, 30 S.V.City Building, Office Tower 2, Floor 17-18 Rama 3 Road, Bangkokpang, Yannawa, Bangkok 10120 Tel : +66-2-662-8522
Indonesia	P.T. Autoteknindo SUMBER MAKMUR Jl. Muara Karang Selatan Blok a Utara No.1 Kav. No.11 Kawasan Industri/Pergudangan Jakarta - Utara 14440 Tel : +62-21-663-0833
India	Messung Systems Pvt.Ltd. Electronic Sadan NO:111 Unit No15, M.I.D.C BHOSARI, PUNE-411026, India Tel : +91-20-712-2807
Australia	Mitsubishi Electric Australia Pty. Ltd. 348 Victoria Road, PostalBag, No 2, Rydalmere, N.S.W 2116, Australia Tel : +61-2-9684-7777

MITSUBISHI ELECTRIC CORPORATION
HEAD OFFICE : 1-8-12, OFFICE TOWER 2 14F HARUMI CHUO-KU 104-6212, JAPAN
NAGOYA WORKS : 1-14, YADA-MINAMI 5-CHOME, HIGASHI-KU, NAGOYA, JAPAN

When exported from Japan, this manual does not require application to the Ministry of Economy, Trade and Industry for service transaction permission.

Specifications subject to change without notice. Printed in Japan on recycled paper.